

### *The Office*

The ideal room for small meetings and one to one interviews and appraisals.

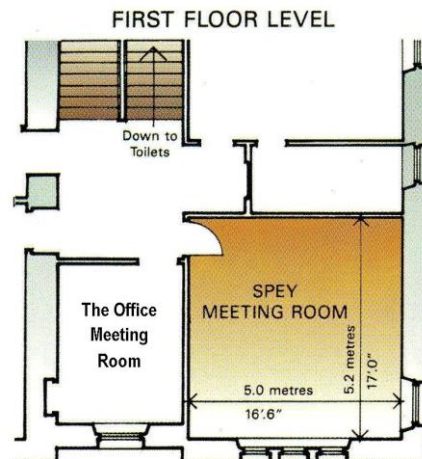

### *The Moray Room*

This front facing room is adjacent to the hotel restaurant which makes it ideal for breakfast meetings and working lunches.

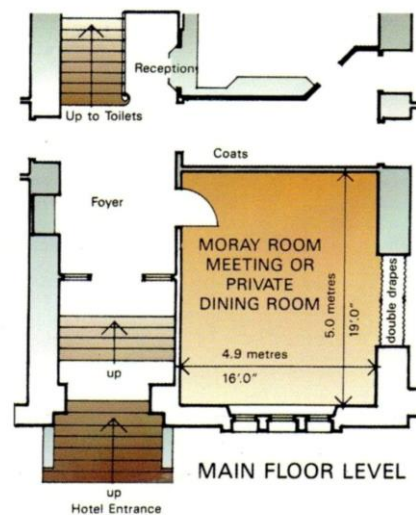

### *The Spey Room*

Filled with natural daylight from its large bay window, The Spey Room makes an ideal boardroom for up to 15 delegates. It can also accommodate up to 30 people theatre style for presentations or talks.

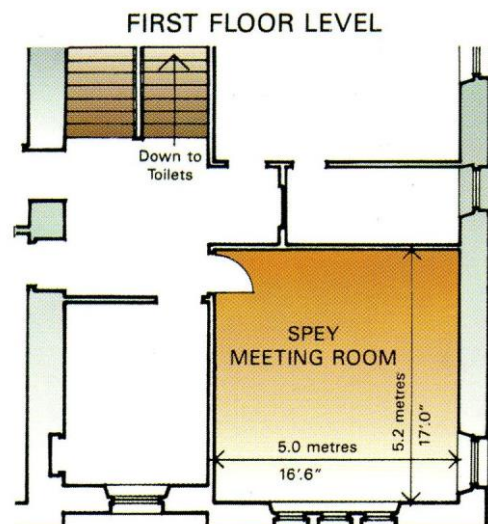

## The Maisondieu Suite

### *The Maisondieu Suite*

Its unique split level design means that the Maisondieu Suite has a flexibility of purpose which allows it to cater for meetings and groups from 15-200. On the ground floor it can cater for up to 200 delegates seated theatre style for presentations.

The upper level is ideal for boardroom and classroom layout and can also cater for up to 80 set theatre style. It can also be used in conjunction with the lower level as a syndicate space or, indeed, for the serving of delegate meals or beverages.

